

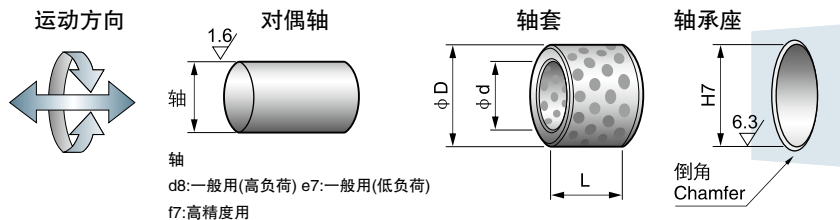

请从适用的内径、外径、长度中选择零件号  
(例)内径25mm、外径33mm、长度20mm的情况下

**NTB-50 - 253320**

请指定上述零件号



内径		外径		长度 L $\begin{smallmatrix} -0.1 \\ -0.3 \end{smallmatrix}$							
$\varnothing d$		$\varnothing D$		8	10	12	15	16	19	20	25
6	+0.022 +0.010 +0.028 +0.013	10	+0.015 +0.006 +0.018 +0.007	061008	061010	061012					
8	"	12	"	081208	081210	081212	081215				
10	"	14	"	101408	101410	101412	101415			101420	
12	+0.034 +0.016	18	"	121808	121810	121812	121815	121816	121819	121820	121825
13	"	19	+0.021 +0.008		131910	131912	131915			131920	131925
14	"	20	"		142010	142012	142015			142020	142025
15	"	21	"		152110	152112	152115	152116		152120	152125
16	"	22	"		162210	162212	162215	162216	162219	162220	162225
17	"	23	"				172315				
18	"	24	"		182410	182412	182415	182416		182420	182425
19	+0.041 +0.020	26	"				192615			192620	
20	"	28	"		202810	202812	202815	202816	202819	202820	202825
"	"	30	"		203010	203012	203015	203016		203020	203025
22	"	32	+0.025 +0.009			223212	223215			223220	223225
25	"	33	"			253312	253315	253316		253320	253325
"	"	35	"			253512	253515	253516		253520	253525
28	"	38	"							283820	283825
30	"	"	"			303812	303815			303820	303825
"	"	40	"			304012	304015			304020	304025
31.5	+0.050 +0.025	"	"								
32	"	42	"							324220	
35	"	44	"							354420	354425
"	"	45	"							354520	354525
38	"	48	"								
40	"	50	"				405015			405020	405025
"	"	55	+0.030 +0.011				405515				
45	"	"	"								
"	"	56	"								
"	"	60	"								

注：本公司可以按客户需求，生产非标产品。Note: we can produce as per your drawings.





请从适用的内径、外径、长度中选择零件号  
(例)内径80mm、外径96mm、长度70mm的情况下

**NTB-50 - 809670**

请指定上述零件号

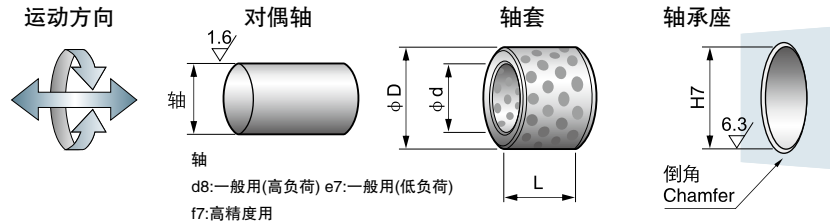

内径		外径		长度 L <sup>-0.1</sup> / <sub>-0.3</sub>							
∅ d		∅ D		20	30	35	40	50	60	70	80
50	+0.050 +0.025	60	+0.030 +0.011	506020	506030	506035	506040	506050	506060	506070	506080
"	"	62	"		506230	506235	506240	506250	506260	506270	506280
"	"	65	"		506530		506540	506550	506560	506570	506580
55	+0.060 +0.030	70	"		557030	557035	557040	557050	557060	557070	
60	"	74	"		607430	607435	607440	607450	607460	607470	607480
"	"	75	"		607530	607535	607540	607550	607560	607570	607580
63	"	"	"						637560	637570	637580
65	"	80	"				658040	658050	658060	658070	658080
70	"	85	+0.035 +0.013		708530	708535	708540	708550	708560	708570	708580
"	"	90	"					709050	709060	709070	709080
75	"	"	"					759050	759060	759070	759080
"	"	95	"						759560	759570	759580
80	"	96	"				809640	809650	809660	809670	809680
"	"	100	"				8010040	8010050	8010060	8010070	8010080
85	+0.071 +0.036	"	"						8510060		8510080
90	"	110	"					9011050	9011060		9011080
100	"	120	"					10012050	10012060	10012070	10012080
110	"	130	+0.040 +0.015					11013050		11013070	11013080
120	"	140	"							12014070	12014080
125	+0.083 +0.043	145	"								
130	"	150	"								13015080
140	"	160	"								
150	"	170	"								15017080
160	"	180	"								16018080
170	"	190	+0.046 +0.017								
180	"	200	"								
190	+0.096 +0.050	210	"								
200	"	230	"								

注：本公司可以按客户需求，生产非标产品。Note: we can produce as per your drawings.

为了防止脱落。推荐使用止动销

- 能在旋转、摇动以及往复运动中使用。
- 不能在海水中使用。
- 内径31.5mm・63mm的轴套能适用于油压气缸中间轴套颈套上。

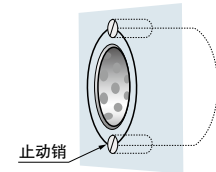
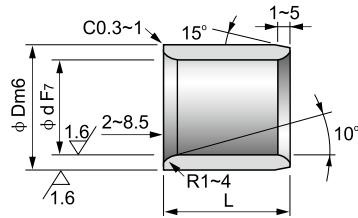

长度 L $\begin{smallmatrix} -0.1 \\ -0.3 \end{smallmatrix}$							压入后 内径公差	适用垫圈 SPW	内径 $\varnothing d$
90	100	120	130	140	150	200			
							+0.045 +0.020	5008	50
							"	"	"
	5065100						"	"	"
							+0.055 +0.025	5508	55
							"	6008	60
	6075100						"	"	"
							"	6508	63
							"	6508	65
	7085100						+0.054 +0.024	7010	70
							"	"	"
	7590100						"	7510	75
	7595100						"	"	"
	8096100	8096120					"	8010	80
	80100100	80100120		80100140			"	"	"
							+0.065 +0.030	9010	85
9011090	90110100	90110120					"	9010	90
10012090	100120100	100120120		100120140			"	10010	100
	110130100	110130120					+0.064 +0.029	12010	110
12014090	120140100	120140120		120140140			"	12010	120
	125145100	125145120					+0.076 +0.036	-	125
	130150100		130150130				"	"	130
	140160100			140160140			"	"	140
	150170100				150170150		"	"	150
	160180100				160180150		"	"	160
	170190100				170190150		"	"	170
	180200100				180200150		"	"	180
	190210100				190210150		+0.088 +0.042	"	190
					200230150	200230200	"	"	200

\*压入后内径公差为参考值。